



10th

World Junior Wushu Championships

REGULATIONS



March 23–31, 2026



Tianjin, China

International Federation
recognised by the



International
Olympic
Committee

Version 3, issued on November 23, 2025 by IWUF

Note: Any changes in the latest version have been marked with an asterisk (*).

© International Wushu Federation

Lausanne Office: Avenue de Rhodanie 58, 1007 Lausanne, Switzerland

Beijing Office: 9 Huaweili, Chaoyang District, 100021 Beijing, China

www.iwuf.org



CONTENTS

I. GENERAL INFORMATION

1. INTRODUCTION	1
1.1 China Overview	1
1.1.1 Geography	1
1.1.2 Climate	1
1.1.3 Population, Ethnicity and Language	1
1.1.4 Religion	2
1.1.5 Others	2
1.2 Tianjin Overview	2
1.3 International Airport	3
1.4 Weather	3
1.5 Electricity	3
1.6 Telephone	4
2. INTRODUCTION TO WORLD JUNIOR WUSHU CHAMPIONSHIPS	4
3. DATES AND PLACE	4
3.1 Competition Date	4
3.2 Important Dates	4
3.2.1 Preliminary Entry	4
3.2.2 Final Entry	4
3.2.3 Late Entry and Changes	4
3.3 Competition Place	4
4. VENUES	4
4.1 Competition Venue	5
4.2 Training Venue	5
5. GENERAL PROGRAM	5
6. KEY CONTACTS	6

II. TECHNICAL INFORMATION

7. COMPETITION EVENTS	7
7.1 Taolu Events	7
7.1.1 Youth Events	7



7.1.2 Junior Events	7
7.1.3 Children's Events	7
7.2 Sanda Events	8
7.2.1 Youth Events	8
7.2.2 Junior Events	8
8. AGE CATEGORIES	8
8.1 Youth Age Group	8
8.2 Junior Age Group	8
8.3 Children Age Group	8
9. QUALIFICATIONS	8
9.1 Membership	8
9.2 Athlete Eligibility	9
10. PARTICIPATION METHODS	9
10.1 Quota	9
10.1.1 Quota for NF	9
10.1.2 Quota for Taolu Team	9
10.1.3 Quota for Sanda Team	10
10.2 Participation Events	10
10.2.1 Taolu Competition	10
10.2.2 Sanda Competition	11
10.3 Relevant Documents	11
11. COMPETITION RULES	12
12. COMPETITION METHODS	12
12.1 Taolu Competition Methods	12
12.1.1 Preliminaries and Finals	12
12.1.2 Routine Time Limits	12
12.1.3 Accompanying Music	13
12.1.4 Roll-Call	13
12.2 Sanda Competition Methods	13
13. COSTUMES AND EQUIPMENT	14
13.1 Compliance Requirement of Marketing and Advertising	14
13.2 Uniforms, Weaponry and Equipment Requirements for Competition	14
13.2.1 Taolu Competition	14
13.2.2 Sanda Competition	14
13.3 Clothing Requirements for Opening and Closing Ceremonies	15
13.4 Clothing Requirements for Awards Ceremony	15
13.5 Compliance Check at Roll-Call Area	15



14. PLACING AND AWARDS	15
14.1 Taolu Competition	15
14.2 Sanda Competition	15
14.3 Participation Certificate	16
15. AWARDS CEREMONY	16
15.1 Medalists	16
15.2 Athletes and Team Officials	16
15.3 Special Cases	16
15.3.1 Medalist Absence	16
15.3.2 Insufficient Participants	16
16. ENTRIES	16
16.1 Preliminary Entry	16
16.2 Final Entry	17
16.3 Late Entry and Changes Policy	17
17. ARRIVALS AND ACCREDITATION	18
17.1 Arrivals	18
17.2 Accreditation	18
18. WEIGH-IN	19
19. TECHNICAL MEETING	19
20. DRAWING OF LOTS	19
21. TECHNICAL OFFICIALS	20
21.1 International Technical Officials (ITOs)	20
21.1.1 Registration	20
21.1.2 Uniforms	20
21.1.3 Judges' Refresher Course	20
21.2 National Technical Officials (NTOs)	20
22. SUPERVISORY COMMISSION	20

III. TEAM INFORMATION

23. ACCOMMODATION	22
23.1 Hotel Reservation	22
23.1.1 Non-Compliance Policy	22
23.1.2 Reservation Principles	22
23.1.3 Meal Arrangements	22
23.1.4 Early Arrival and Late Departure Requirements	22
23.2 Room Assignment Rules	22



23.2.1 Teams with Odd Number of Delegates	23
23.2.2 Team Judges	23
23.3 Hotels Information	23
23.3.1 Team Hotels	23
23.3.2 VIP & Judge Hotel	25
24. TRANSPORTATION	26
24.1 Transport Services for Arrivals and Departures	26
24.2 Shuttle Services	26
25. FINANCIAL CONDITIONS	26
25.1 Teams	26
25.2 Technical Officials	27
25.3 Additional Costs	27
25.4 Payment Methods	27
26. DOPING CONTROL AND EDUCATION	28
26.1 Doping Control	28
26.2 Anti-doping Education	28
27. RESPONSIBILITY OF MEMBER FEDERATIONS	28
27.1 Fundamental Principles	28
27.2 Attitude of Athletes and Coaches	29
27.3 Image of Athletes	29
28. INSURANCE	29
29. PASSPORT AND VISA REQUIREMENTS	29
30. ANNEX	29
Annex 1	30
Annex 2	32
Annex 3	34

I. GENERAL INFORMATION

1. INTRODUCTION

1.1 China Overview

China, one of world' s most ancient civilizations, has a history dating back over 5,000 years. This has led to the country having an extraordinarily rich cultural heritage. As the world's largest developing country, China has seen remarkable progress in its economic and social development. Today's China is politically and socially stable, and economically prosperous, with its people's lives getting better each day.

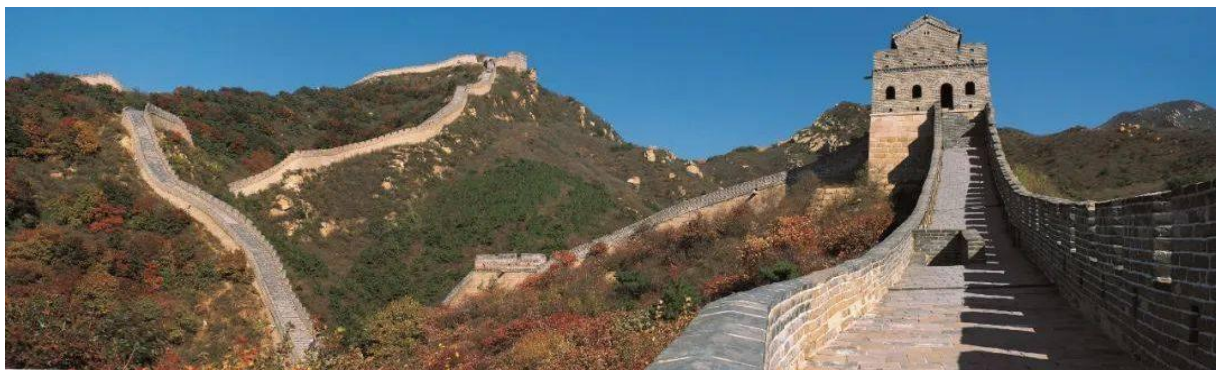

1.1.1 Geography

China is located on the east side of Asia and the west edge of the Pacific Ocean. Covering a land area of about 9.6 million square kilometers, it features over 18,000 kilometers of continental coastline along its eastern and southern edges, and approximately 4.7 million square kilometers of inland and border seas. There are more than 7,600 islands of varying sizes in the sea area, among which the island of Taiwan, with an area of 35,798 square kilometers, is the largest.

1.1.2 Climate

Given its sheer size, it is perhaps not surprising that China has a range of climates. Most of the country lies in northern temperate zone that features a mild, continental monsoon climate and four distinct seasons.

1.1.3 Population, Ethnicity and Language

Population: 1,411.78 million.

Ethnicity: China is a multi-ethnic country with 56 ethnic groups in total.

Language: There are more than 80 local languages and about 30 Chinese writing systems. Mandarin



(also known as Putonghua) is the country's national language.

1.1.4 Religion

Religion: China is a multi-religious country. The main religions are Buddhism, Taoism, Islam, Catholicism and Christianity. Chinese citizens enjoy freedom of religious belief.

1.1.5 Others

China shares borders with 14 countries and is adjacent to eight countries by sea. The capital city is Beijing. China is comprised of provincial-level administrative divisions that can be further classified into: 4 municipalities directly under the central government, 23 provinces, 5 autonomous regions and 2 Special Administrative Regions.

Currency: The legal currency is renminbi (RMB), with yuan as the basic unit, and jiao and fen as fractions of this basic unit. One yuan is equal to 10 jiao and one jiao equal to 10 fen. Foreign currency can be freely exchanged in most hotels and banks on the Chinese mainland.

1.2 Tianjin Overview

Tianjin, abbreviated as “Jin” and historically referred to as Jingu or Jinmen, is one of the four municipalities directly under the Central Government of the People’s Republic of China. As a national central city and megacity, Tianjin is situated on the western coast of the Pacific Ocean, in the northeastern part of the North China Plain, at the lower reaches of the Haihe River Basin. It borders the Bohai Sea to the east, the Yanshan Mountains to the north, and Beijing to the west, with Hebei Province surrounding it on all other sides. Tianjin sits at the confluence of the five major tributaries of the Haihe River, earning it titles such as the “Downstream Terminus of Nine Rivers” and a “Strategic Junction of River and Sea”. The city experiences a warm temperate, semi-humid monsoon climate with distinct seasons. The municipality is administratively divided into 16 districts, with a total area of 11,966.45 square kilometers. As of the end of 2024, Tianjin’s permanent resident population was 13.64 million.



Tianjin rose to prominence due to its strategic position in the imperial grain transport system. On December 23, 1404 (the 21st day of the 11th lunar month in the 2nd year of the Yongle era of the Ming Dynasty), the city was officially established, making it the only ancient Chinese city with a precisely documented founding date. Over more than 600 years, Tianjin has developed a distinctive blend of Eastern and Western architectural styles and a mix of historical and modern cultural elements.

Tianjin has emerged as a pivotal national center - a city celebrated for its rich history and culture, while serving as a modern maritime hub. As northern China's premier logistics and manufacturing center, it functions as a major international transportation nexus, a national leading advanced manufacturing and R&D base, the core international shipping hub in northern China, and a pilot zone for financial innovation and operations. Strategically positioned, Tianjin serves as a primary node on the China-Mongolia-Russia Economic Corridor, a strategic pivot on the Maritime Silk Road, a critical junction along the Belt and Road Initiative, and the easternmost starting point of the Eurasian Land Bridge. Additionally, it provides vital sea access for landlocked neighboring countries and remains the largest port city in northern China, while acting as both gateway and strategic buffer for the capital region.

1.3 International Airport

Tianjin Binhai International Airport (IATA: TSN, ICAO: ZBTJ) is located in Dongli District, approximately 13 kilometers from the city center. As a 4E-class civil international civil airport, it serves as a national air logistics hub, an international scheduled flight airport, a first-class international aviation port, and a major air cargo hub in China. At present, Tianjin Binhai International Airport operates 155 flight routes, with 3,647 scheduled flights per week, connecting 127 domestic and international cities.



1.4 Weather

Historical average temperatures for Tianjin in March range from 9°C–15°C.

1.5 Electricity

The electricity standard in China is 220V (50Hz).



1.6 Telephone

To call China from abroad, dial +86 (country code) followed by city code, followed by the local number.

2. INTRODUCTION TO WORLD JUNIOR WUSHU CHAMPIONSHIPS

Hosted by the International Wushu Federation (IWUF), the World Junior Wushu Championships (WJWC) is the official pinnacle junior championships of the IWUF and features its highest competitive level amongst its junior athletes. This biennial event began in 2006, and since then nine editions have been held. The 10th WJWC will be held in Tianjin, China from March 23 to 31, 2026. The Chinese Wushu Association is responsible for the organization of the 10th WJWC under the auspices of the IWUF.

For more information on the 10th WJWC, please visit the IWUF official website <http://www.iwuf.org>, also visit the official social media, Facebook, Instagram (IG), YouTube.

3. DATES AND PLACE

3.1 Competition Date

(all the following dates and times in Beijing Time)

From March 26 to 30, 2026

3.2 Important Dates

3.2.1 Preliminary Entry

From November 23 to December 22, 2025

3.2.2 Final Entry

From December 23, 2025 to February 7, 2026

3.2.3 Late Entry and Changes

(upon acceptance by IWUF)

From February 8 to March 7, 2026

3.3 Competition Place

Tianjin, China

4. VENUES



Tianjin Gymnasium, built in December 1994 and located on Binshui West Road in Tianjin, is a large-scale, comprehensive, and multifunctional facility hosting sports events, performances, exhibitions, and public fitness activities. The complex occupies a total area of 12.23 hectares, with a total floor space exceeding 50,000 square meters. Due to its distinctive saucer-shaped architecture, locals nickname it “The Flying Saucer” or “The Big Arena”. It has also been prominently featured in China Central Television (CCTV) broadcasts and is recognized nationwide as a symbol of Tianjin. The venue consists of four major sections: the saucer-shaped main arena, a sub arena, a training hall, and a media center, along with supporting facilities. The main arena alone covers 24,677 square meters, with a height of 35 meters, a span of 108 meters, and a steel space-frame dome with a diameter of 135 meters.



Venue Address: No. 393 Binshui West Road, Nankai District, Tianjin

4.1 Competition Venue

Tianjin Gymnasium Main Competition Venue

4.2 Training Venue

Tianjin Gymnasium Training Hall

5. GENERAL PROGRAM

Date	Time	Activity	Location
Mar. 23 (Mon)	Whole Day	Team Arrivals and Registration	Team Hotel*
	Whole Day	Judges Arrivals and Registration	Judges Hotel*
Mar. 24 (Tue)	Whole Day	Team Arrivals and Registration	Team Hotel*
	Whole Day	Team Training	Tianjin Gymnasium
	Whole Day	Judges' Refresher Course	TBD
Mar. 25 (Wed)	06:30–08:00	Weigh-In	TBD
	Whole Day	Team Training	Tianjin Gymnasium
	09:00–12:00	Judges' Refresher Course	TBD
	10:00–12:00	Technical Meeting and Drawing of Lots	TBD
	15:00–17:00	Judges' Rehearsal	Tianjin Gymnasium



(Continued)

Mar. 26 (Thur)	06:30–07:30	Weigh-In	TBD
	Whole Day	Competition and Awards Ceremony	Tianjin Gymnasium
Mar. 27 (Fri)	06:30–07:30	Weigh-In	TBD
	Whole Day	Competition and Awards Ceremony	Tianjin Gymnasium
Mar. 28 (Sat)	06:30–07:30	Weigh-In	TBD
	Whole Day	Competition and Awards Ceremony	Tianjin Gymnasium
Mar. 29 (Sun)	06:30–07:30	Weigh-In	TBD
	Whole Day	Competition and Awards Ceremony	Tianjin Gymnasium
Mar. 30 (Mon)	06:30–07:30	Weigh-In	TBD
	Whole Day	Competition and Awards Ceremony	Tianjin Gymnasium
Mar. 31 (Tue)	Before 14:00	Departures	

★ Note: This program is subject to change depending on the number of the registered athletes.

6. KEY CONTACTS

●IWUF Secretariat

Tel: +86-10-87774492

Email: events@iwuf.org

●Chinese Wushu Association (CWA)

Contact person: TIAN Ye/WANG Jiaqi

Tel: +86-10-64912153

Email: wushu@wushu.com.cn

●Organizing Committee of 10th WJWC

(hereinafter referred to as "Local Organizing Committee", abbreviated as "LOC")

Local Organizer: Tianjin Gymnastics, Wushu, Shooting, and Archery Sports Management Center

Contact person: Zhang Yuan

Tel: +86 022 87182098

Email: styjtcwszx@tj.gov.cn



II. TECHNICAL INFORMATION

7. COMPETITION EVENTS

7.1 Taolu Events

(The numbers in parentheses indicate the number of movements in the compulsory routines. E.g., Taijiquan (42) means 42 movements in its routine.)

7.1.1 Youth Events

- **Boys' and Girls' Events**

- **3rd Set of International Wushu Competition Routines**

Bare-hand routines: Changquan (59), Nanquan (63), and Taijiquan (36)

Short weapon routines: Jianshu (64), Daoshu (53), Nandao (63), Taijijian (39), and Taijishan (40)

Long weapon routines: Qiangshu (54), Gunshu (51), and Nangun (66)

- **Optional Duilian (Choreographed sparring) Routines**

Duilian (2-person or 3-person Duilian, no mixed gender)

7.1.2 Junior Events

- **Boys' and Girls' Events**

- **1st Set of International Wushu Competition Routines**

Bare-hand routines: Changquan (62), Nanquan (65), and Taijiquan (42)

Short weapon routines: Jianshu (53), Daoshu (58), Nandao (68), and Taijijian (42)

Long weapon routines: Qiangshu (53), Gunshu (50), and Nangun (68)

- **Optional Duilian (Choreographed sparring) Routines**

Duilian (2-person or 3-person Duilian, no mixed gender)

7.1.3 Children's Events

- **Boys' and Girls' Events**

- **Elementary Routines**

Bare-hand routines: Changquan No.3 (34), Nanquan (34), and Taijiquan (24)



Short weapon routines: Jianshu (34), Daoshu (34), Nandao (34), and Taijijian (32)

Long weapon routines: Qiangshu (30), Gunshu (34), and Nangun (34)

7.2 Sanda Events

7.2.1 Youth Events

- **Boys' Events**

- 48kg, 52kg, 56kg, 60kg, 65kg, 70kg, 75kg, and 80kg

- **Girls' Events**

- 48kg, 52kg, 56kg, and 60kg

7.2.2 Junior Events

- **Boys' Events**

- 42kg, 45kg, 48kg, 52kg, and 56kg

8. AGE CATEGORIES

8.1 Youth Age Group

***Taolu: 15–17** years of age (born between November 14, 2008 - December 31, 2011)

(Note: Age for Dakar 2026 YOG is between November 14, 2008 - 31 October, 2011)

***Sanda: 15–17** years of age (born between January 1, 2009 – December 31, 2011)

8.2 Junior Age Group

***12–14** years of age (born between January 1, 2012 – December 31, 2014)

8.3 Children Age Group

***11** years of age and below (born in and after January 1, 2015)

9. QUALIFICATIONS

9.1 Membership

- Only those federations/associations which have paid their IWUF annual membership fees for 2025 will be permitted to participate in the 10th WJWC.
- New IWUF member federations may be invited to take part in the 10th WJWC after their membership



applications have been accepted by the IWUF.

Hereinafter the IWUF member federation is referred to as "NF".

9.2 Athlete Eligibility

- Athletes must be citizens of the country/territory that they are representing.
- Athletes who have dual citizenship can only represent one country/territory in the 10th WJWC.
- *In cases where athletes have changed their citizenship, such athletes are required to have resided in the country or territory that they are representing for at least two (2) years prior to the opening day of the competition or activity, during which time they may not have represented any other country or territory in any international competition.
- *Pursuant to the above, pursuant to the provisions of the Olympic Charter applying subsidiarily, the Technical Committee shall deal with all disputes relating to an athlete's eligibility for participation and report to the IWUF Executive Board for a final decision.

10. PARTICIPATION METHODS

10.1 Quota

10.1.1 Quota for NF

Each NF can enter at most **1 team**. Each team can be composed of both **taolu** and **sanda** members.

Each NF can enter a maximum of **35 members** with up to 19 members for taolu team and 16 members for sanda team.

10.1.2 Quota for Taolu Team

Each taolu team shall be composed of a maximum of **19 members**.

- **Athlete**

Each team may, at most, enter **14 athletes** including:

- **Youth Athletes:** 6 athletes (a maximum of 3 boys and 3 girls)
- **Junior Athletes:** 4 athletes (a maximum of 2 boys and 2 girls)
- **Children's Athletes:** 4 athletes (a maximum of 2 boys and 2 girls)

- **Team Official**

Each team may, at most, enter **4 team officials** including:



- 1 team leader
- 2 coaches
- 1 doctor

- **Team Judge**

Each team may, at most, enter **1 taolu team judge**.

- **Observer**

Extra team delegate(s) exceeding the quota shall be registered as observer(s).

10.1.3 Quota for Sanda Team

Each sanda team shall be composed of a maximum of **16 members**.

- **Athlete**

Each team may, at most, enter **11 athletes** including:

- **Youth Athletes:** 8 athletes (a maximum of 5 boys and 3 girls)
- **Junior Athletes:** 3 athletes (a maximum of 3 boys)

- **Team Official**

Each team may, at most, enter **4 team officials** including:

- 1 team leader
- 2 coaches
- 1 doctor

- **Team Judge**

Each team may, at most, enter **1 sanda team judge**.

- **Observer**

Extra team delegate(s) exceeding the quota shall be registered as observer(s).

10.2 Participation Events

10.2.1 Taolu Competition

- **Youth Athletes**

Each team may enter at most **1 Men's Duilian** and **1 Women's Duilian** events in Youth



group. Each Youth athlete may enter at most **4 competition events** including:

- 1 bare-hand routine
- 1 short weapon routine
- 1 long weapon routine
- 1 optional Duilian routine

NOTE: Athletes can enter **both Taijijian and Taijishan routines** in weapons routines.

- **Junior Athletes**

Each team may enter at most **1 Men's Duilian** and **1 Women's Duilian** events in Junior group. Each Junior athlete may enter at most **4 competition events** including:

- 1 bare-hand routine
- 1 short weapon routine
- 1 long weapon routine
- 1 optional Duilian routine

- **Children's Athletes**

Each Children's athlete may enter at most **3 competition events** including:

- 1 bare-hand routine
- 1 short weapon routine
- 1 long weapon routine

10.2.2 Sanda Competition

- **Youth Athletes**

- Each team may enter at most **1 Youth athlete per weight category**.
- Each Youth athlete may enter only **1 weight category**.

- **Junior Athletes**

- Each team may enter at most **1 Junior athlete per weight category**.
- Each Junior athlete may enter only **1 weight category**.

10.3 Relevant Documents

Upon arrival at the Accreditation Desk, team leaders must present the following documents:

- Completed and signed **Waiver of Liabilities** (Annex 1) of all participants, which must be signed by



his/her parent or legal guardian for the participant who is under 18 years of age.

- **Medical Certificates** (Annex 2) of all athletes issued by a qualified medical doctor from a check-up performed within a period of **15 days** prior to the date of registration at the competition.
- **Life Accidental Injury Insurance Certificates** of all athletes.

11. COMPETITION RULES

Unless otherwise stated within these regulations, the competition will be conducted in accordance with:

- IWUF Wushu Taolu Competition Rules and Judging Methods (2024).
- IWUF Wushu Sanda Competition Rules and Judging Methods (2024).

Hereinafter the IWUF Wushu Taolu Competition Rules and Judging Methods (2024), and the IWUF Wushu Sanda Competition Rules and Judging Methods (2024) are referred to as “rules”.

The rules may be interpreted solely at the discretion of the IWUF. In the event of language discrepancies in the rules, the English version shall prevail.

12. COMPETITION METHODS

12.1 Taolu Competition Methods

Within taolu competition, the “Events without Degree of Difficulty Scoring Methods and Standards” will be implemented.

12.1.1 Preliminaries and Finals

- **Preliminaries**
 - In the case when the number of participants in an event exceeds **50 athletes**, the athletes will be divided randomly and evenly into several groups by the computer for preliminaries.
 - The athletes' start order of each group in preliminaries is determined by a drawing of lots.
- **Finals**
 - The finals consist of **12 athletes**. Equal numbers of top finishers from each group will qualify for the finals.
 - The athletes' start order in finals is determined by a drawing of lots that will be held **1 day prior to the date of finals**.

12.1.2 Routine Time Limits



- Changquan, Nanquan, Jianshu, Daoshu, Qiangshu, Gunshu, Nandao and Nangun routines: Not less than 1 minute 10 seconds in total duration
- Taijiquan (36), Taijijian (39) and Taijishan (40) routines: From 3 to 4 minutes in total duration
- Taijiquan (42) routines: From 5 to 6 minutes in total duration
- Taijijian (42) routines: From 4 to 5 minutes in total duration
- Optional Duilian routines: From 50 seconds to 1 minutes in total duration
- Elementary routines: No requirements for the routine performance duration

12.1.3 Accompanying Music

- Accompanying music is required for:
 - 1st Set of International Wushu Competition Routines: Taijiquan (42), Taijijian(42)
 - 3rd Set of International Wushu Competition Routines: Taijiquan (36), Taijijian (39), Taijishan (40)
- Each NF must upload the accompanying music through the IWUF Online Registration System with their final entry submission. **NFs shall be responsible for the music copyright used.**
- Accompanying music with vocals and/or lyrics is not permitted.

12.1.4 Roll-Call

- Athletes shall report to the designated Roll-call Area at:
 - 30 minutes prior to the start of the event (first roll-call)
 - 20 minutes prior to the start of the event (second roll-call)
 - 10 minutes prior to the start of the event (final roll-call)
- Failure to be present for roll-call will result in forfeit.

12.2 Sanda Competition Methods

12.2.1 Competition Format

- The competition will utilize the single-knockout system.
- If the number of athletes in a given weight category is 3, a single round-robin competition system will be adopted.
- The duration of each round shall be 1 minute 30 seconds with a 1-minute rest in between.

12.2.2 Permitted and Prohibited Techniques

- **Youth Competition**



Athletes may strike the opponent's head with kicks and continuous punches.

- **Junior Competition**

Athletes may continuously punch the opponent's head, but kicking the opponent's head is strictly prohibited.

12.2.3 Daily Weigh-In

- Following arrival and accreditation, athletes will undergo an initial weigh-in and drawing of lots as stipulated in the schedule.
- Athletes competing on a specific day of competition are required to weigh-in at the specific time and place prior to the start of the day's event.

13. COSTUMES AND EQUIPMENT

13.1 Compliance Requirement of Marketing and Advertising

All teams must follow the IWUF Brand Control Guidelines for Wushu Competition Uniforms (excerpt) (Annex 3).

13.2 Uniforms, Weaponry and Equipment Requirements for Competition

13.2.1 Taolu Competition

Athletes shall wear wushu competition costumes and use the competition weaponry in compliance with the rules during all events.

- All athletes must provide their own uniforms and weaponry.
- 2 competition bibs (20cm*15cm) for each athlete's use will be provided by the LOC to the teams upon accreditation. The athlete should show his/her competition bib to the Head Judge before he/she enters the competition mat.

13.2.2 Sanda Competition

Athletes shall wear costumes and protective gear in compliance with the rules to participate in the competition.

- Each athlete must provide 2 sets of competition uniforms: 1 set in red and 1 set in blue.
- Each athlete must provide their own gum guard, groin cup, hand wraps, instep guard and **shin guard (applicable for junior competition)**. Otherwise, participation in the competition will not be permitted.



- Gloves, headgear and chest protector manufactured by the IWUF's certified supplier(s) will be provided by the LOC.

13.3 Clothing Requirements for Opening and Closing Ceremonies

All teams must wear their official national/territorial team uniforms at the Opening and Closing Ceremonies.

13.4 Clothing Requirements for Awards Ceremony

Medalists are expected to attend the Awards Ceremony in their national/territorial team uniforms.

13.5 Compliance Check at Roll-Call Area

Uniforms and weapons checks will be conducted at the Roll-call Area in accordance with stated regulations and requirements. Uniforms and weapons checks are conducted by the Chief Registrar and the Roll-call Officials as stipulated in the rules. Non-compliance may be subject to disqualification from the competition.

14. PLACING AND AWARDS

14.1 Taolu Competition

- **1st place:** Gold medal and Certificate
- **2nd place:** Silver medal and Certificate
- **3rd place:** Bronze medal and Certificate
- **4th–8th place:** Certificate

Awarding for taolu events will be respectively as follows:

- **1st–8th place:** If the actual number of participates is 10 and above in a single event.
- **1st–5th place:** If the actual number of participates is between 6 and 9 in a single event.
- **1st–2nd place:** If the actual number of participates is between 3 and 5 in a single event.

No awards will be bestowed if the actual number of participates is 2 or less athletes in a single event.

14.2 Sanda Competition

- **1st place:** Gold medal and Certificate
- **2nd place:** Silver medal and Certificate
- **3rd place (juxtaposition):** Bronze medal and Certificate



14.3 Participation Certificate

All accredited personnel, including team leaders, coaches, doctors, observers and athletes will receive a 10th WJWC participation certificate.

Team leaders are required to collect the participation certificates, as well as the award certificates of athletes placing 4th–8th (if applicable), at the Results and Certificates Office.

15. AWARDS CEREMONY

15.1 Medalists

Medalists must:

- Attend the Awards Ceremony to receive their medals **in person**.
- Be escorted by staff to the Waiting Area **10 minutes** before the ceremony to prepare accordingly.
- Not bring any national/territorial, cultural or religious symbols onto the podium.
- Remove caps, hats, and sunglasses throughout the Awards Ceremony.
- Face the flags during they are being raised.

15.2 Athletes and Team Officials

Athletes and team officials are required to remain in the designated area.

15.3 Special Cases

15.3.1 Medalist Absence

- In case a medalist is unable to attend the ceremony for a valid reason, his/her medal and certificate may be presented to the appointed official of the team.
- Absence without a valid reason will result in forfeiture of the right to receive a medal.

15.3.2 Insufficient Participants

If there are fewer than 3 medalists in a single event, no Award Ceremony will be held for that event. The team leader will receive the medals and certificates at the Results and Certificates Office.

16. ENTRIES

16.1 Preliminary Entry

Preliminary entry must be submitted through ***the IWUF Online Registration System***.



- ***IWUF Online Registration System***

URL: <https://registration.iwuf.org>

Contact person: HUANG Xilong

Tel: +86-19952270889

Email: Service@jyywty.com

Tech-support: Jiangyin Yunwu Shiwu Sports Technology Co., Ltd

Online preliminary entry will open from **November 23, 2025**, and close at **23:59** on **December 22, 2025**.

All teams must state the number of athletes and team officials as accurately as possible taking part in the events so that the LOC may reserve the hotels and prepare the organization of the event accordingly. There is no guarantee for hotel rooms reservation for teams failed to submit their preliminary entry before the required deadline.

All teams are required to complete their online preliminary entry before the deadline to access the final entry system.

16.2 Final Entry

Final entry must be submitted through ***the IWUF Online Registration System***.

All sections of the online entry must be completed in full, including the uploading of the following documents:

- Photos of the participants (white background, head filling 70-80% of the photo, at least 480 pixels in width and 600 pixels in height)
- Passports of the participants (must be valid for at least **6 months** following their final day of travel)

Online final entry will open from **December 23, 2025**, and close at **23:59** on **February 7, 2026**.

All payments due to the LOC must be paid in full for registration to be considered as completed.

Each team is required to print a copy of the submitted entry and present it to the LOC upon registration.

16.3 Late Entry and Changes Policy

After the final entry deadline, teams must submit a confirmation document with signature via email to events@iwuf.org*. Teams shall pay corresponding fees before the late entry and changes deadline, otherwise request will be denied.

Late entry and changes will open from **February 8, 2026**, and close at **23:59** on **March 7, 2026**.



Any request to change the entry (including the late entry) will be handled as follows:

- The late entry is subject to the approval of the IWUF and, if accepted, it will incur a late-entry fee of **USD 100** per participant.
- Replacing a participant is subject to approval by the IWUF and, if accepted, it will incur a replacement fee of **USD 100** per participant.
- If changes are required due to incorrect or missing registration information, those changes are subject to approval by the IWUF and, if accepted, it will incur a fee of **USD 50** per change.

Late Entry	Replacement	Information Change
USD 100	USD 100	USD 50

The above fees must be paid via wire transfer to the IWUF before **23:59** on **March 7, 2026**.

17. ARRIVALS AND ACCREDITATION

17.1 Arrivals

The following accredited personnel are required to register with the LOC at the LOC-designated hotels no later than:

- **Team judges: 23:59** on **March 23, 2026**
- **Athletes and team officials: 23:59** on **March 24, 2026**

17.2 Accreditation

Accreditation Desks will open at **09:00** on **March 23, 2026**.

Upon arrival at the Accreditation Desk, team leaders are required to complete the following process:

1	Present each team members' passports
2	Submit Final Entry Form with signature and stamp and confirm the registration information
3	Submit 3 national flags (size: 1m*2m)
4	Submit national anthem (short version) in MP3 format on a CD or USB flash drive
5	Submit signed Waiver of Liabilities of all participants (Annex 1)
6	Submit valid Medical Certificates (Sample) of all athletes (Annex 2)
7	Submit valid Life Accidental Injury Insurance Certificates of all athletes
8	Pay the relevant participation fees in full (if applicable)



9	Pay the relevant penalty fees in full (if applicable)
10	Submit a bank receipt of payment (either in paper or electronic documents)
11	Sign and confirm all the above items are completed

Accreditation cards will be given to the team leader upon completion of the accreditation process. All personnel must participate in the official activities with their accreditation cards during the 10th WJWC.

The competition and training schedules will be distributed after accreditation has concluded.

18. WEIGH-IN

The first official weigh-in for all athletes will take place at **06:30** on **March 25, 2026**. Furthermore, the weigh-in will be conducted on daily basis at **06:30**, athletes must attend a weigh-in on each day they participate in competition (specific places for each weigh-in will be announced accordingly).

Accreditation cards and passports must be presented at each weigh-in session. A sanda athlete's failure to attend any required weigh-in will result in his/her disqualification from the competition.

19. TECHNICAL MEETING

The technical meeting for team managers and coaches will take place at **10:00** on **March 25, 2026**. Each team should send 1–3 representative(s) to attend the meeting. The place of the technical meeting will be announced in due course.

The technical meeting content will be presented as follows:

- IWUF Event Guidelines (IWUF representatives)
- Event Logistics Information (LOC representatives)
- Event Technical Details (Chair of Jury of Appeals and Chief Referee)
- Other Matters

20. DRAWING OF LOTS

After the technical meeting, the drawing of lots will be conducted by the scheduler-recorder group supervised by the Jury of Appeals and the Chief Referee on **March 25, 2026**.

The drawing of lots for taolu and sanda disciplines will be held simultaneously in two separate rooms. Each team should send 1–2 representative(s) for each discipline to attend the sessions.

The Jury of Appeals will draw on behalf of the teams that are unable to send a representative to attend.



21. TECHNICAL OFFICIALS

21.1 International Technical Officials (ITOs)

- Each team may send at most **1 taolu team judge** and **1 sanda team judge** to officiate at the 10th WJWC subject to approval of the IWUF.
- The IWUF will select and appoint the independent judges and the Jury of Appeals at its discretion to serve at the 10th WJWC.
- All team judges and independent judges of the 10th WJWC must hold their valid IWUF Judge's License at the time of the competition.

21.1.1 Registration

- The information for the team judges must be submitted at the time of their team registration.
- The Jury of Appeals and all independent judges appointed by the IWUF shall submit their registration information through **the IWUF Online Registration System**.
- All team judges and independent judges of the 10th WJWC must input their valid IWUF Judge's License numbers through the online registration system.

21.1.2 Uniforms

All ITOs shall prepare their own black jackets, white shirts, black slacks, and black leather shoes, as well as bring the IWUF ties/scarfs.

21.1.3 Judges' Refresher Course

- All 10th WJWC judges are required to participate in the judges' refresher course.
- Absence without a valid reason will forfeit the right to officiate at the 10th WJWC.

21.2 National Technical Officials (NTOs)

All NTOs serving at the 10th WJWC will be nominated by the LOC.

22. SUPERVISORY COMMISSION

The 10th WJWC Supervisory Commission shall be established by the IWUF, with the purpose of and the right to resolve any disputes or investigate any issues that arise during the course of this competition to ensure the smooth execution of the event.

The Supervisory Commission for an IWUF competition consists of 3–5 members appointed by the President of the IWUF and is responsible for overseeing the competition management and dispute mediation for the entire



duration of this competition and not beyond. Specific descriptions of responsibilities include:

- The Commission will ensure that competitions adhere to principles of fair play, impartiality, and transparency.
- The Commission represents the IWUF in handling disputes regarding the competitions that arise between the NFs and/or teams and/or LOC, and has the right to resolve such disputes. However, the Commission does not directly interfere with the competition proceedings or disputes arise within the competition, which are responsibility of the Jury of Appeals and the relevant judging panel.
- The Commission represents the IWUF in coordinating between the NFs and/or teams and/or LOC.
- The Commission shall report any irregularities or violations observed during the competitions to the IWUF President and the IWUF Executive Board.
- The Commission shall monitor and demand that NFs take responsibility for their athletes' general attitude and comportment.



III. TEAM INFORMATION

23. ACCOMMODATION

23.1 Hotel Reservation

All accredited personnel are required to stay at the LOC-designated hotels.

- **Check-in Time:** After **15:00**
- **Check-out Time:** Before **14:00**

23.1.1 Non-Compliance Policy

Teams unable to stay at the LOC-designated hotels due to special reasons shall pay a participation fee of **USD 200** per person. In this case:

- Teams are fully responsible for their own accommodation, meals, and transportation.
- LOC shall not be held liable for any consequences arising therefrom.

23.1.2 Reservation Principles

- Hotel reservations are available on a **first-come, first-served** basis.
- Early reservations are **strongly recommended** due to limited availability.

23.1.3 Meal Arrangements

The LOC will provide meals for all accredited personnel:

- From the evening of their arrival date to the midday on their departure date
- 3 meals daily (breakfast, lunch, and dinner)

23.1.4 Early Arrival and Late Departure Requirements

Participants wishing to arrive or depart outside the scheduled dates must:

- Submit their intended arrival and departure dates during the final registration process.
- Confirm accommodation bookings accordingly, with daily rates applicable.

NOTE: Teams wishing to check in before **15:00** on **March 24** must book their accommodation starting from **March 23**.

23.2 Room Assignment Rules

23.2.1 Teams with Odd Number of Delegates

Teams with an odd number of delegates (including athletes, team officials and observers) when having reserved double rooms, the LOC will assign the extra delegate to share a double room with a member from another team, if the individual chooses not to pay for a single room.

23.2.2 Team Judges

Team judges reserving double rooms will be paired with other team judges by the LOC.

23.3 Hotels Information

23.3.1 Team Hotels

- **Renaissance Tianjin Lakeview Hotel (5-star)**

Address: No.16 Binshui Road, Hexi District, Tianjin

Telephone: +86-22-58223388

The distance to Tianjin Gymnasium is 2.3km (12 minutes by bus).

Renaissance Tianjin Lakeview Hotel consists of two guestroom buildings (front and rear), an office building, and a conference center. All guest rooms are equipped with standard in-room amenities, such as hair dryers, refrigerators, and the hotel offers a range of on-site amenities, including business center, ticketing office, shopping arcade, beauty salon and hairdresser, fitness center, Karaoke lounge and post office. The hotel also has 5 restaurants and bars.



Accreditation Category	Participation Fee Per Person Per Night	
	Single Room Only one person allowed	Double Room Two persons allowed
In-quota athletes and team officials	USD 165	USD 140
Observer(s)	USD 175	USD 150



- **Tianjin Meijiang Crowne Plaza Hotel (5-star)**

Address: No. 2, Tuanjie Building, East Side of Youyi South Road, Meijiang Subdistrict, Hexi District, Tianjin

Telephone: +86-22-58576666

The distance to Tianjin Gymnasium is 6.3km (14 minutes by car).

The hotel is a business and conference hotel with a lake-side view, set away from the city centre. The hotel consists of two buildings - the main building and the apartment building. It has a variety of distinct catering facilities, including 3 restaurants and bars, as well as 1 gourmet lounge. A stylishly designed fitness club and swimming pool.

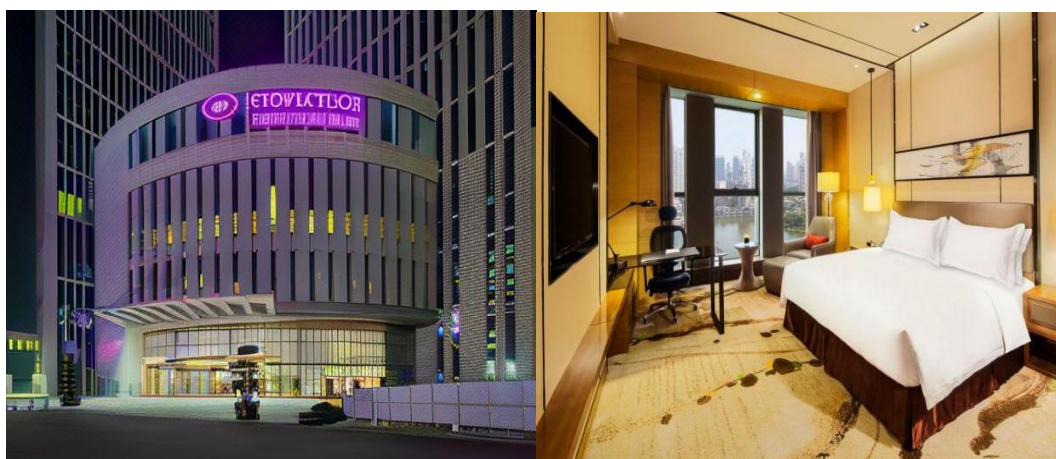

Accreditation Category	Participation Fee Per Person Per Night	
	Single Room Only one person allowed	Double Room Two persons allowed
In-quota athletes and team officials	USD 165	USD 140
Observer(s)	USD 175	USD 150

- **Tianjin Saixiang Hotel (5-star)**

Address: No. 8 Meiyuan Road, Huayuan Industrial Zone, Xiqing District, Tianjin

Telephone: +86-22-23768888

The distance to Tianjin Gymnasium is 6.2km (15 minutes by car).

Tianjin Saixiang Hotel is located in the southwestern part of Tianjin, at the heart of the Huayuan Industrial Zone within the city's New Technology Industrial Park. It is a five-star business hotel that integrates accommodation, conference services, dining, and fitness. The

guestrooms are spacious, elegantly furnished, and fully equipped with intelligent amenities.



Accreditation Category	Participation Fee Per Person Per Night	
	Single Room Only one person allowed	Double Room Two persons allowed
In-quota athletes and team officials	USD 145	USD 125
Observer(s)	USD 155	USD 135

23.3.2 VIP & Judge Hotel

- **Tianjin Crystal Palace Hotel** (4-star)

Address: No. 28 Youyi Road, Hexi District, Tianjin

Telephone: +86-22-28356888

The distance to Tianjin Gymnasium is 2.3km (10 minutes by car).

The hotel, recently renovated, features 266 rooms with picturesque lake views. In addition, the second floor offers 'Xuxiang Pavilion' for modern urban cuisine, while the first floor features 'Jingpin Yue' for Cantonese dim sum and tea, the Lakefront Art Center, the 'Yacan' bar, the Jing Space multi-functional area, and the 'Mao You Quan'. These new facilities make it a suitable venue for conferences.



Accreditation Category	Participation Fee Per Person Per Night	
	Single Room Only one person allowed	Double Room Two persons allowed
Judges	USD 120	USD 100

24. TRANSPORTATION

24.1 Transport Services for Arrivals and Departures

Transport services between Tianjin Binhai International Airport, Tianjin Railway Station, Tianjin South Railway Station, Tianjin West Railway Station, and the official hotels will be provided by the LOC for all accredited personnel on their arrival and departure dates.

- **Pick-Up: March 23 and 24, 2026** (from the airport and railway stations to the hotels)
- **Drop-Off: March 31, 2026** (from the hotels to the airport and railway stations)

24.2 Shuttle Services

Shuttle buses will operate between the official hotels and the competition and training venues. Schedules will be contributed on arrival.

25. FINANCIAL CONDITIONS

25.1 Teams

- Any international or domestic airfare and related travel expenses, as well as the participation fees of all participants shall be borne by themselves.
- The participation fees include accommodation, meals, airport pickup and drop-off, local transportation, entry (excluding the late entry and changes fees) and certificate, etc.



25.2 Technical Officials

- The international airfare, accommodation and meals shall be provided for the appointed independent judges and the Jury of Appeals by the LOC.
- The expenses above for the team judges shall be borne by their teams themselves.

25.3 Additional Costs

Participants arriving early or departing late may be subject to additional costs related thereto which shall be borne by the participants themselves.

25.4 Payment Methods

- All teams are required to complete full payment in advance to the LOC by **23:59** on **February 7, 2026** through international wire transfer. Until complete payment is received, hotel rooms will not be reserved, and accreditation will not be issued.
- Teams that are unable to pay through international remittance due to government policies and restrictions should communicate with the LOC in advance to make arrangements, otherwise accreditation will not be issued.
- All international wire transfer and bank fees are to be paid by the teams transferring the funds themselves.
- Proof of full payment should be sent to the LOC by email and brought along to the LOC by the team leader. The LOC requires that all participation fees are to be paid in advance in order to secure accommodation as required by the official hotels. The LOC will be unable to guarantee a team's required accommodation without pre-payment in full. Teams are requested to be mindful of this when submitting their final entry.
- The Bank information of the LOC :

Bank Name	BANK OF CHINA LTD. TIANJIN SHIYINGLU SUB-BRANCH
Account Name	Tianjin Gymnastics, Wushu, Shooting and Archery Sports Management Center
Account Number (IBAN):	268801493504
SWIFT Code	BKCHCNBJ200



Beneficiary Bank Holder Address	5th Floor, Research Building, Tuanbo Sports Center, Health Industry Park, Jinghai District, Tianjin, CHINA
Bank Address	NO.32 SHIYING ROAD, NANKAI DISTRICT, TIANJIN, CHINA
Note: Any service charges incurred for international wire transfers shall be borne by participants themselves.	

26. DOPING CONTROL AND EDUCATION

26.1 Doping Control

Doping control will be conducted during the 10th WJWC according to the requirements of the International Olympic Committee (IOC) and the World Anti-Doping Agency (WADA), and will follow the procedure prescribed in the IWUF Anti-Doping Rules. The number of tests will be decided by the International Testing Agency (ITA). If an athlete is found have positively doped through the doping process, he/she will be dealt with in accordance with the IWUF Anti-Doping Rules.

26.2 Anti-doping Education

WADA/ITA certified education courses are **mandatory** to participate in the 10th WJWC for athletes, at least one of the medical personnel and the team coach. To ensure your successful accreditation and participation in the 10th WJWC, please carefully comply with the mandatory anti-doping requirements. More detailed information of anti-doping education course will be released shortly.

27. RESPONSIBILITY OF MEMBER FEDERATIONS

The IWUF member federations (NFs) are responsible for their officials, coaches, athletes, doctors, team judges and observers adhering to the IWUF and to all relevant rules established by the IWUF and the LOC. NFs should ensure that their participants hold themselves to the highest standards in all their actions during the event.

27.1 Fundamental Principles

All NFs' members participating in the 10th WJWC must observe and respect the IWUF constitution, rules, regulations, and representatives. Individuals deemed to have acted against the IWUF, its principles, interests or purpose may be subject to suspension or expulsion from the event and/or cancellation of



their accreditation.

27.2 Attitude of Athletes and Coaches

The athletes will compete under the responsibility of their NFs. The NFs are fully responsible regarding the general attitude and comportment of their athletes. Coaches should respect the judging panel and all complaints must be conducted in accordance with competition procedures. Athletes and coaches should comply with the IWUF Code of Ethics. Any act against the IWUF judging panel may be subject to suspension or expulsion from the event and/or cancellation of their accreditation and/or competition results.

27.3 Image of Athletes

Each NF is responsible for obtaining the rights for the IWUF to use its athletes' images at the discretion of the IWUF for promotional purposes in all forms.

28. INSURANCE

Each NF is fully and sole responsible for insuring its athletes against injury and third-party risk (public liability) during the period of the 10th WJWC. The IWUF and the LOC are not responsible in part or in whole of the said liability.

29. PASSPORT AND VISA REQUIREMENTS

All participants must hold a valid passport and should allow plenty of time for visa application and processing.

To ensure as few complications during visa application and travel as possible, it is suggested that all participants' passports are valid for at least 6 months following their final day of travel.

*Teams that require visa invitation letters should state their requests in the Entry Form and provide participant list and passport details via email to tianye@wushu.com.cn before **March 13, 2026**.

*If you need any assistance on visa issues, please contact the Chinese Wushu Association and LOC via email.

NOTE: We ***strongly recommend*** teams that need to apply for visas do so ***as early as possible***.

30. ANNEX

Annex 1: Waiver of Liabilities

Annex 2: Medical Certificate (Sample)

Annex 3: IWUF Brand Control Guidelines for Wushu Competition Uniforms (excerpt)



Annex 1

**10th World Junior Wushu Championships
Waiver of Liabilities**

Federation				Color ID Photo
Name of Participant				
Date of Birth		Gender		
Nationality		Passport No.		
Role of Participant				
*Athlete *Team Manager *Coach *Doctor *Observer				

I, the undersigned, knowingly and without duress, do voluntarily submit my Entry to the 10th World Junior Wushu Championships (WJWC). The 10th World Junior Wushu Championships is hosted by International Wushu Federation (IWUF) and organized by the Chinese Wushu Association and the City of Tianjin, hereinafter the Chinese Wushu Association and the City of Tianjin are referred as the "Organizing Committee". I understand and acknowledge that the participation in the 10th World Junior Wushu Championships involves inherent risk of losses, damages or injuries, including but not limited to risks deriving from participating in the competition and trainings, in the use of the sporting facilities or equipment and/or risks arising from actions or omissions of other participants or other third parties. I further understand that my participation in the 10th World Junior Wushu Championships is subject to my agreement and acceptance of this Waiver of Liabilities ("Waiver"). In consideration of the IWUF and the Organizing Committee accepting my application, I hereby assume all risk of physical and mental injuries, disabilities and losses which may result from or in connection with my participation in the 10th World Junior Wushu Championships. Acting for myself, heirs, personal officers, agents, representatives and assignees, I do hereby release, to the extent permissible, the IWUF and the Organizing Committee including all associates, auxiliaries and affiliates, such as but not limited to their officers, agents, employees, representatives, volunteers, judges and referees and other related members from all claims, actions, suits, and controversies related to any loss, damage or injury by reason of any matter, cause or thing whatsoever that I may sustain as a result of or in connection with my participation in the 10th World Junior Wushu Championships. I fully understand and acknowledge that it is my sole responsibility to determine whether I am fit and healthy enough to participate in any events without posing a risk to myself or others. I hereby certify that, to the best of my knowledge, this is the case. I understand to have a duty to inspect the state of the used sporting facilities and equipment, and I waive any claim arising out of any respective defect. I fully understand that all medical attention or treatment afforded to me by the IWUF and the Organizing Committee including all associates, auxiliaries and affiliates, e.g. their officers, medical personnel, representatives, employees, volunteers, and all other related members, will be of the first aid type only, and I hereby consent to receiving such treatment and release the IWUF and the Organizing Committee as well as their officers, representatives, volunteers, employees and all other related members from any liability for such aid. I understand it is my personal obligation to obtain my own medical coverage. I am fully and solely responsible for adequately insuring myself against injury and third-party risk (public liability), with such insurance to cover the period before, during and



after the event. The IWUF and the Organizing Committee including all associates are not responsible in part or in whole for any damages or medical or hospital expenses incurred as a result of participation in the 10th World Junior Wushu Championships.

I agree to abide by and follow the Rules established by the IWUF and the Organizing Committee and follow all received instructions. I acknowledge and agree that it is my personal responsibility to be informed about all afore-mentioned Rules and instructions. I agree that I will conduct myself in a professional and courteous manner at all times and to be subject to penalties and sanctions for violations related thereto, pursuant to the IWUF Constitution and the IWUF Ethics Code as updated from time to time and other Rules established by the IWUF and the Organizing Committee. I understand that any dispute must be resolved in accordance with the IWUF Constitution and any further applicable IWUF Rules. I agree that my performance, attendance, and participation at the 10th World Junior Wushu Championships may be photographed, filmed or otherwise recorded or released or telecast live. I consent to allow the IWUF and the Organizing Committee use of my name, likeness, address, voices, poses, pictures, videos, live or non-live coverage and biographical and biological data concerning full or parts, in any form or language ("Identity, Voice and Image Data"), with or without other material, throughout the world, without limitation, for television, radio, video, theatrical medium picture, or any other medium and any other purpose by the IWUF or the Organizing Committee through any devices now known or hereafter devised and I do hereby waive any compensation in regard thereof as well as any future rights to the aforementioned. I also consent to the collecting, processing and use of all above-mentioned Identity, Voice and Image Data by the IWUF and the Organizing Committee for commercial and promotional services of sponsors and media partners as well as, where necessary, by third parties for the purpose of facilitating my participation an accreditation in the event (e.g. law enforcement authorities, border services agencies etc.).

Furthermore, while I note that the IWUF and the Organizing Committee will take into consideration my needs to rest, train and prepare for the events, I agree to be reasonably available during the Events for TV/digital/radio interviews, promotional or press photo sessions and press conferences at the dedicated areas.

If any provision of this Waiver is deemed to be invalid or unenforceable, the remaining provisions shall remain in full force and effect. This Waiver shall be governed by the IWUF Constitution, the further applicable Rules established by the IWUF and the Organizing Committee and, subsidiarily, by Swiss law.

I have read and fully understand the waiver listed above.

****For athletes under the age of 18 -This waiver must be signed by their parent or legal guardian****

Signature of Participant	Signature of Parent/Legal Guardian	Name of Parent/Legal Guardian
	(If participant is under 18 years of age)	
Date	Date	Date



Annex 2

**10th World Junior Wushu Championships
Medical Certificate (Sample)****1. ATHLETE INFORMATION**

Surname				Color ID Photo
Given Name(s)				
Country		Postal Code		
Passport No.		Telephone No.		
Email				
Address				

2. QUESTIONS FOR ATHELETE (Attach relevant documents if you answered 'yes' to any of the following)

Is a doctor currently treating you?	
Have you ever been unconscious or had a concussion?	
Have you been hit hard in the head in the last 6 months?	
Have you had any headache in the last 2 weeks?	
Do you have any problems with bleeding?	
Do any diseases run in your family?	
Have you had any surgery?	
Have you ever had to stay in a hospital?	
Do you have any medical condition?	
Do you have a history of seasonal or drug allergies?	
Is there a history of sudden death under 45 years old in the family?	

3. MEDICAL DOCTOR INFORMATION

Surname	
Given Name(s)	
Telephone No.	
Address	

4. MEDICAL EXAMINATION



Item				Abnormalities
Head	Cranial nerves, eyes, pupil size and reactivity. Fundi. Vision by chart.	Normal	Abnormal	
	Mouth, teeth, throat	Normal	Abnormal	
	Ears	Normal	Abnormal	
	Temporomandibular joint	Normal	Abnormal	
	Brain Examination: electroencephalogram (EEG) Test (Sanda athletes only)	Normal	Abnormal	
Neck	Cervical spine, lymph nodes	Normal	Abnormal	
Chest	Breath sounds, rib, tenderness on compression	Normal	Abnormal	
Neurological System	Reflexes	Normal	Abnormal	
	Verbal responses	Normal	Abnormal	
	Motor responses and balance	Normal	Abnormal	
Cardiovascular System	Heart rate	Normal	Abnormal	
	Blood pressure	Normal	Abnormal	
	Heart examination: electrocardiogram (ECG) Test	Normal	Abnormal	
Medications Used	Name and dosage	Yes	No	

5. DOCTOR CONFIRMATION

I confirm that the Athlete is <input type="checkbox"/> fit / <input type="checkbox"/> not fit to participate in the competition.	Signature: Place/Date:
--	-------------------------------

6. NATIONAL FEDERATION CONFIRMATION

I confirm that the above information provided is true and correct.

National Federation	
Name of Representative	
Title of Representative	
Signature:	Date:



Annex 3

International Wushu Federation (IWUF) Brand Control Guidelines for Wushu Competition Uniforms (excerpt)

1. PURPOSE

To ensure sponsor and manufacture rights by establishing a standard for brand placement on uniforms and other clothing items used during IWUF wushu competition.

2. STANDARDS AND GUIDELINES

Uniforms of athletes, coaches and team officials

3. GENERAL REQUIREMENTS

The manufacturer logo may appear once on each piece of clothing, with an area of up to 20 cm². Note that only the quantity and size of logos appearing on uniforms will be assessed during the competition, and logos will not be reviewed for accuracy or adherence to brand standards.

The manufacturer logo may appear once on each accessory item (paired accessories are considered as two items), with an area of up to 6 cm².

A manufacturer logo may appear once on each shoe or foot item (paired shoes or foot items are considered as two items), with an area of up to 6 cm².

A national/regional Olympic Committee flag, a national/regional wushu federation flag/logo may each appear once where specified, with an area of up to 20 cm² each.

3.1 WUSHU TAOLU COMPETITION UNIFORM REQUIREMENTS

● *Top/Jacket*

○ *Front*

No advertisements or logos may appear on the collar.

A flag may appear on the left chest area, with an area of up to 20 cm².

The manufacturer logo may appear on the right chest area, with an area of up to 20 cm².

No advertisements may appear in other areas.

○ *Back*

Sponsor or other logos may be displayed in other areas. The total number of sponsor or other logos may not exceed three, with a maximum area of 20 cm² each.

● **Pants/Trousers**

○ **Left leg**

The manufacturer logo may be arranged on the top, with an area of up to 10 cm².

Sponsor logos may appear below the manufacturer's logo but may not appear within 5 cm of the manufacturer's logo, with an area of up to 10 cm².

○ **Right leg**

No logo, flag, or other emblem may appear

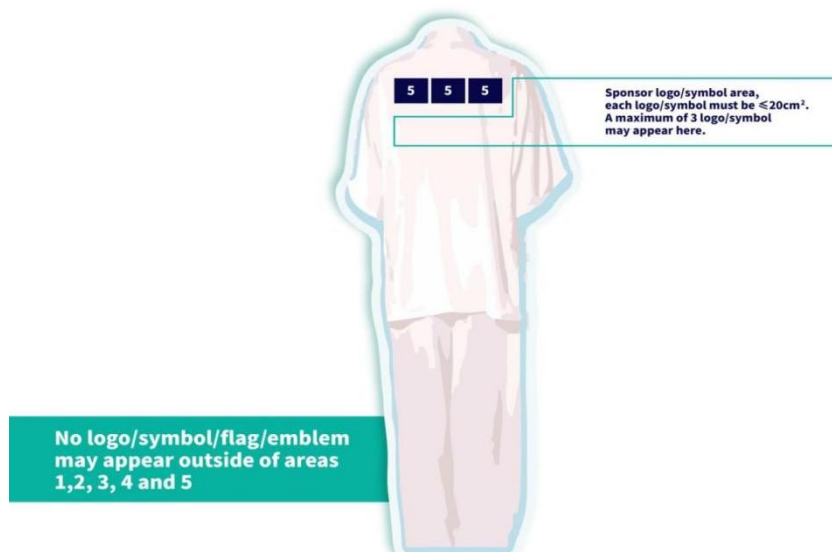
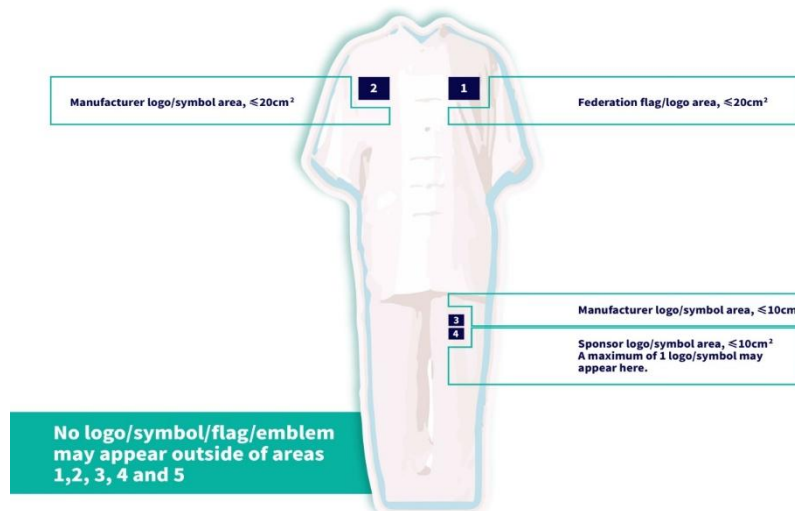

3.2 WUSHU SANDA COMPETITION UNIFORM REQUIREMENTS

● *Top/shirt*

○ *Front*

A flag may appear on the left chest area, with an area of up to 20 cm².

The manufacturer logo may appear on the right chest area, with an area of up to 20 cm².

Sponsor or other logos may be displayed in other areas but may not appear within 5 cm of the flag or manufacturer logo. The total number of sponsor or other logos may not exceed one, with a maximum area of 20 cm².

○ *Back*

Sponsor or other logos may be displayed in back areas. The total number of sponsor or other logos may not exceed three, with a maximum area of 20 cm².

● *Shorts*

○ *Left leg*

The manufacturer logo may be arranged on the top, with an area of up to 10 cm².

Sponsor logos may appear below the manufacturer's logo but may not appear within 5 cm of the manufacturer's logo. The total number of sponsor or other logos may not exceed one, with an area of up to 10 cm².

○ *Right leg*

No logo, flag, or other emblem may appear.





WU UNIVERSITÄT WIEN VIENNA UNIVERSITY OF ECONOMICS AND BUSINESS

IWUF APP



- RECOGNIZED BY / IN PARTNERSHIP WITH -

International Federation
recognised by the



International
Olympic
Committee



INTERNATIONAL SCHOOL SPORT FEDERATION



- OFFICIAL SOCIAL MEDIA PLATFORMS -



- IWUF APP -



- IWUF GLOBAL PARTNER -

恒源祥®



- IWUF GLOBAL SUPPLIER -

TaiShan

